

COPYRIGHT NOTICE:
 This drawing is the copyright of the Architects and may not be reproduced or used except by written permission.

Information for the client: This drawing is the copyright of the Architects and may not be reproduced or used except by written permission. The client is advised that this drawing is for their information only and does not constitute a contract. The client is advised that the Architects are not responsible for the design of the building or the construction of the building. The client is advised that the Architects are not responsible for the design of the building or the construction of the building. The client is advised that the Architects are not responsible for the design of the building or the construction of the building.

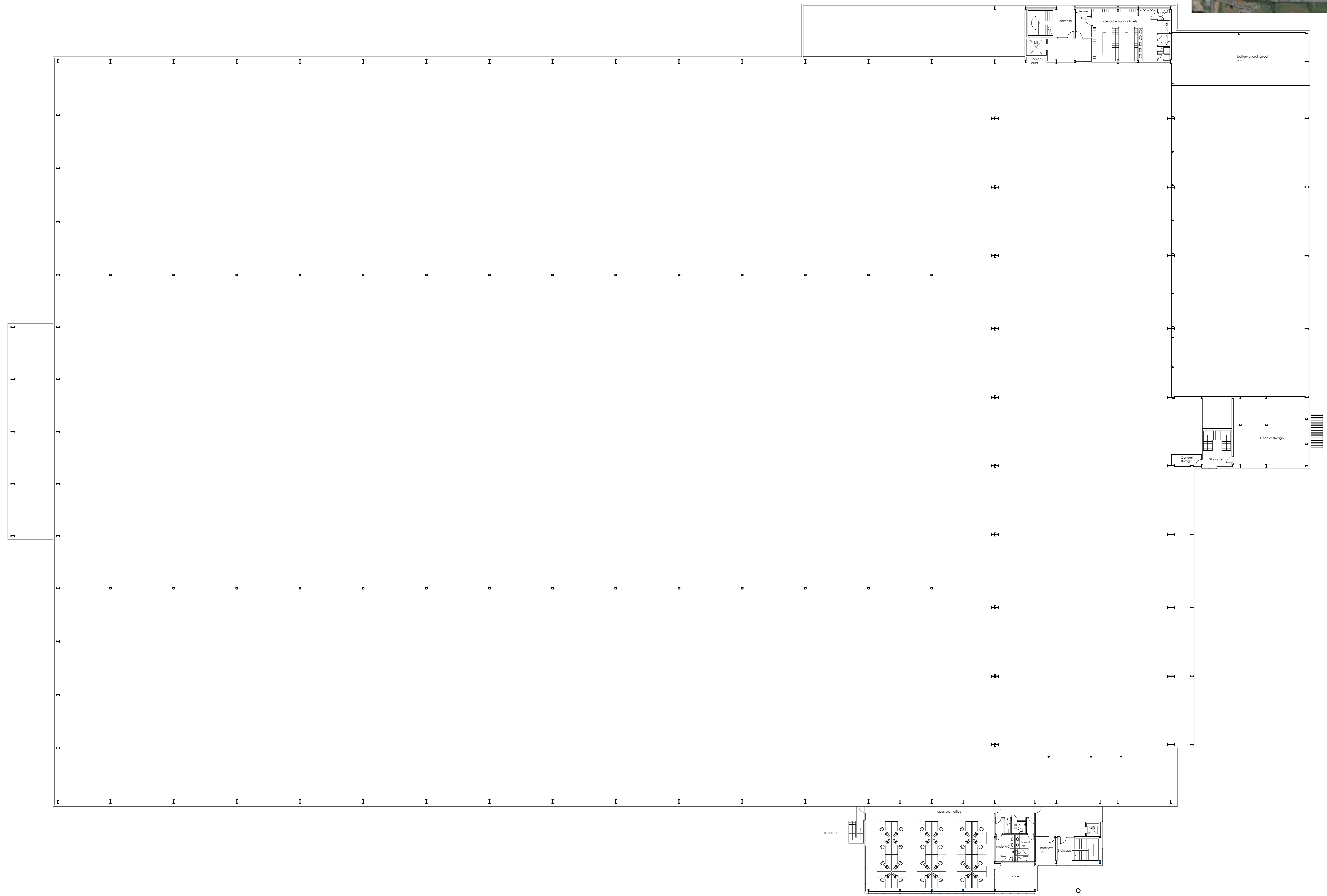
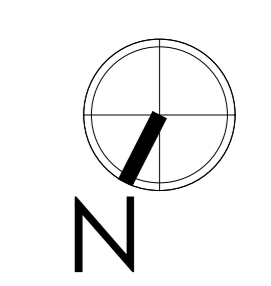

First Floor Plan

F1 210922 Updates following email from client dated 21/09/21:
 • grid lines removed

Revision Notes:

Drawing Details:



Pera Business Park, Nottingham Road
 Melton Mowbray, LE13 0PB
 Telephone: 01534 543 298 Fax: 01534 643 360
 E-Mail: info@hsparchitects.co.uk Web: www.hsparchitects.co.uk

Project:
 Existing Units
 Asfordby Storage
 Melton Mowbray
 For Mather Jamie

Title:
 Existing First Floor Plan - Unit 3

Scale	Drawn	Checked	Date
1:200	SG	JCB	August 21
Drawing No:	Revision:		
8524-03-031	F1		

